

# SERVICES: RE-CONFIGURATION & SPACE PLANNING

Space planning helps you maximize the use of space in your office. It can increase productivity and affect how your team communicates and works together. It's important to periodically evaluate how your office design is functioning. As you grow and expand, re-configuration will keep your functionality and teamwork strong.

**Office Furniture NOW!**  
©2020 Office Furniture NOW!

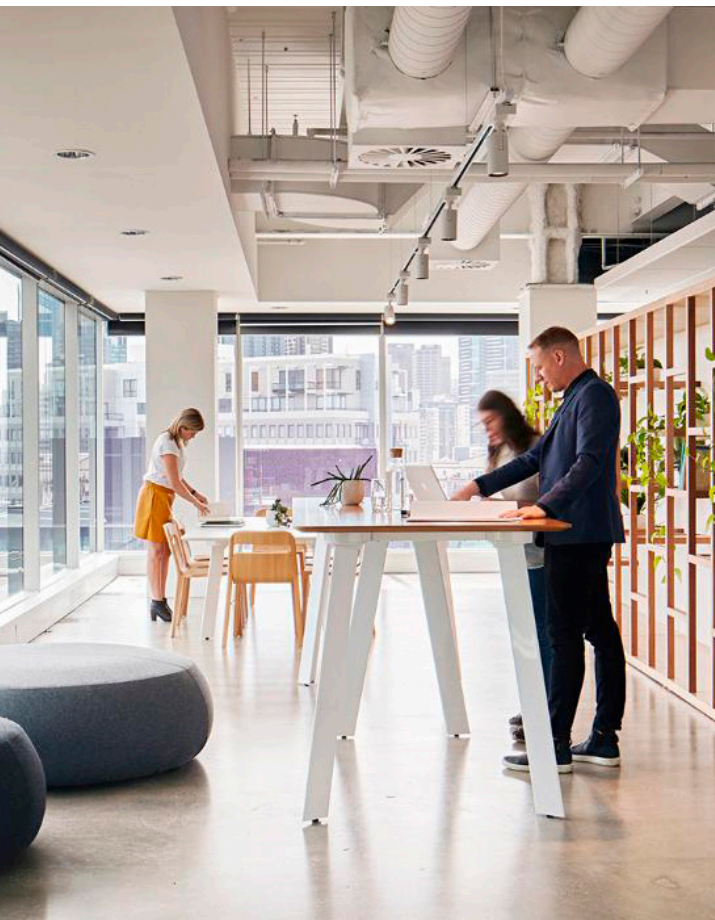

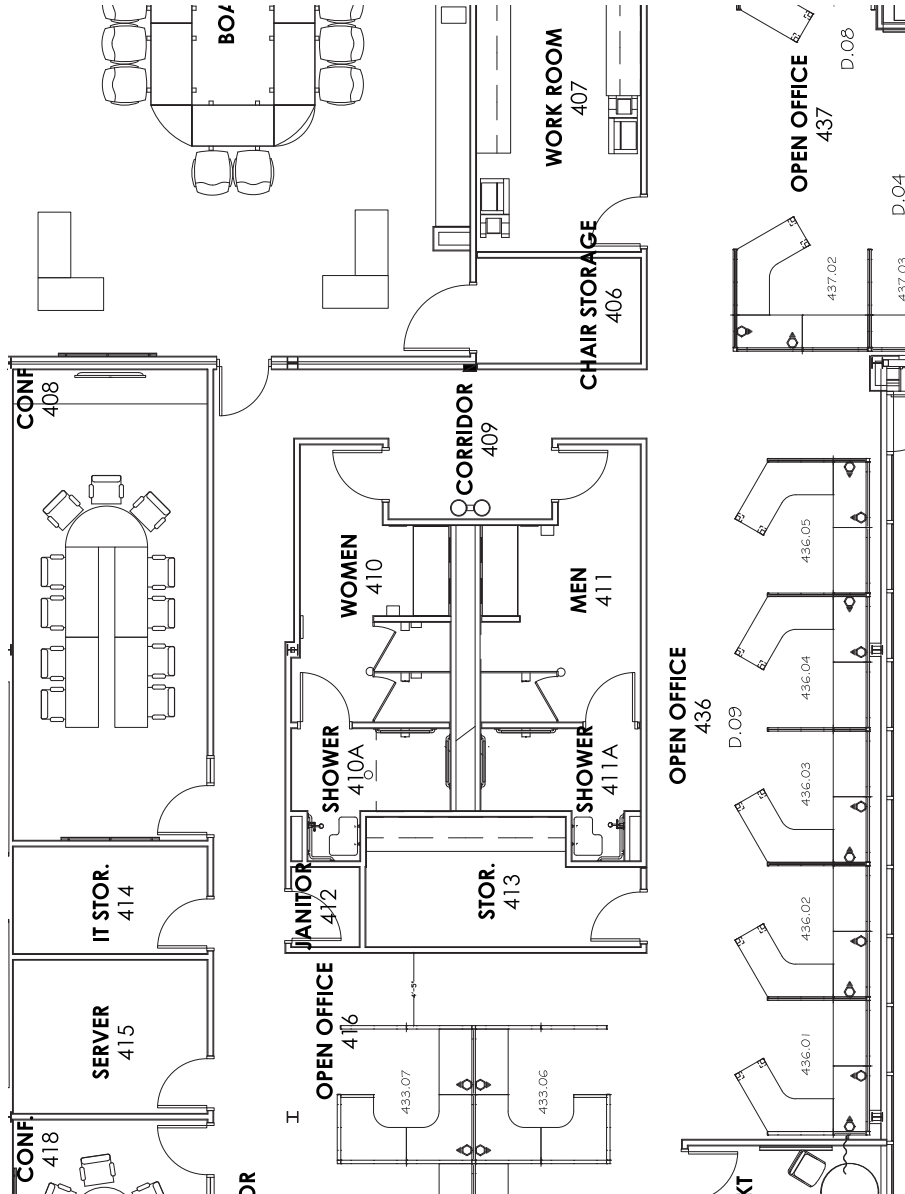

### Re-Configuration

As your business and hiring practices change so do your office furniture requirements and the physical layout of your space.

We reconfigure office furniture layouts for a variety of reasons to recapture efficiencies that have been lost over time.:

- Adding or subtracting furniture
- Increasing collaborative spaces
- Changing your office's layout

When planning an office reconfiguration, obtaining professional CAD drawings is often the first step in visualizing your new office space. Today, many offices are balancing several workstation configurations into one open space. Benching systems, cubicles, and height adjustable desks are coexisting within the same layout.

Cubicle adjustments require experienced design and installation specialists to update. Our team of certified cubicle installers are knowledgeable in all major name-brand modular systems and are experts at re-configuring your office furniture to meet your current needs.

We can work from your existing layout or our knowledgeable Space Planners/Designers can evaluate and then re-design your space, creating drawings for the office furniture reconfiguration. We utilize 3-D computer simulation of your new space so you can see what it will be like beforehand.

Once the office furniture reconfiguration plan is agreed upon, we tear-down, change, install and move any cubicles or furniture to meet your current space and design needs.

If you need additional furniture, we can help you ascertain what works best for your space. If you need less furniture, we can un-install it, take a trade-in for a furniture upgrade, buy it, liquidate it, or store it for you - whatever is best for you under the circumstances. We can also take your digital architectural plans and add office furniture to those floor plans.

### Space Planning

Our experienced space planning & design team can help you ascertain the best colors, selection and arrangement of your new office furniture to ensure your team operates productively. Equipped with the latest computer design software, our designers are highly trained to use it. Starting with your CAD files or new ones we create from scratch. 2D-3D rendering capabilities allow you to easily envision your finished workspace. With professional space planning and design, you will be able to maximize every square foot of office space.

#### Professional space planning can:

- Enhance workplace efficiency
- Increase team work and communication
- Control traffic flow
- Integrate technology, huddle spaces & storage

We encourage startups with vivid imaginations to visit our [Inspired Workspaces](#) design boards for great ideas. Then [schedule a consultation](#) to come visit our showroom full of possibilities, and meet with one of our expert Furniture Consultants to begin your dream office!

**CONTACT US FOR MORE INFORMATION ABOUT OUR SPACE PLANNING SERVICES**